

# ***SURVEYORS CONTINUING EDUCATION CONFERENCE & TRADE SHOW***

**PRESENTED BY**

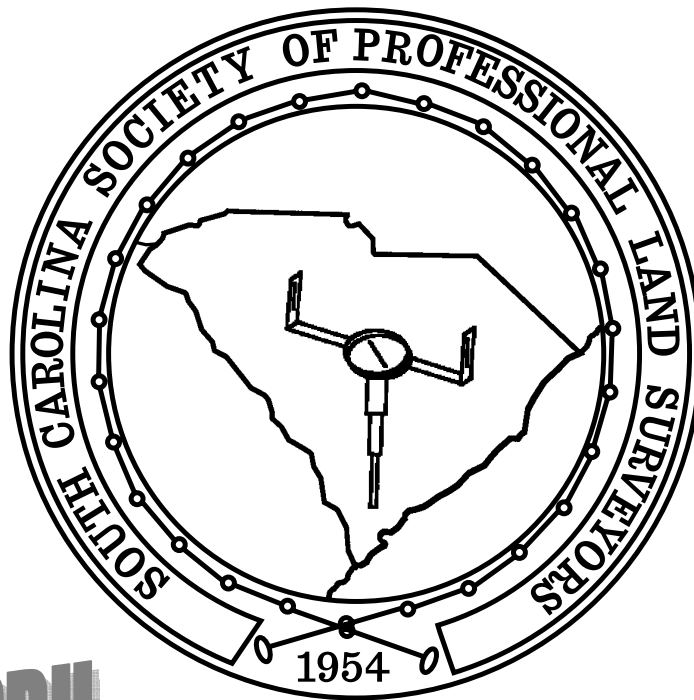

**EARN 15 PDH**

**FEBRUARY 17 - 18, 2011**

**Radisson Hotel Columbia  
2100 Bush River Road  
Columbia, South Carolina**

# Districts of the South Carolina Society of Professional Land Surveyors

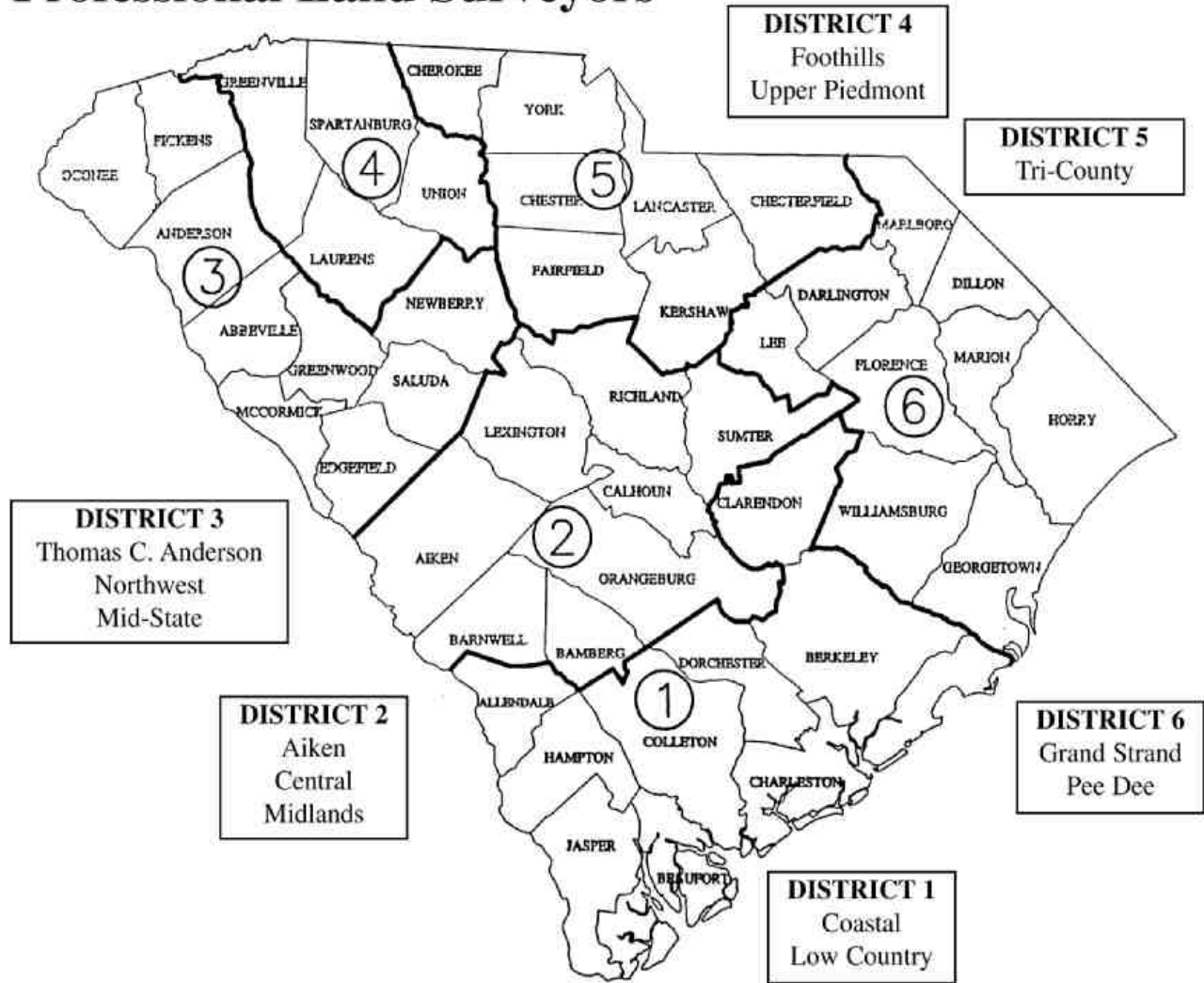

## 2010-11 CHAPTER MEETINGS

CHAPTER	REPRESENTATIVE	PHONE	DATE	LOCATION
Aiken	Bill Tripp	803-642-5776	2 <sup>nd</sup> Tues.	EeJay's Restaurant, Kalmia Mall, Aiken
Central	Thomas Andersen	843-659-5083	2nd Wed.	Various locations, Sumter
Coastal	Nancy Hopper	843-849-0200	Last Tues.	Various locations, Charleston
Foothills	Billy Martin	864-527-4611	2nd Tues.	Golden Corral, Greenville
Grand Strand	Erwin Balk	843-357-1901	3rd Tues.	T-Bones, Murrells Inlet
Low Country	Donald Ray Cook	843-815-5263	2 <sup>nd</sup> Tues.	Various locations, Beaufort
Mid-State	C. A. Shealy, III	803-276-8686	3 <sup>rd</sup> Thurs.	Stable Steak House Restaurant, Prosperity
Midlands	George Bradley, Jr.	803-732-4004	4th Mon.	Carolina Wings, Irmo
Northwest	John R. Long	864-654-5033	2nd Tues.	Circle M BBQ, Liberty
Pee Dee	Ferrell Prosser	843-669-5361	1st Mon.	Thunderbird, I-95 & #52, Florence
Thomas Anderson	Wayne Reynolds	864-456-3506	2nd Tues.	Fatz Café, Greenwood
Tri-County	Bill White	803-327-5758	1st Tues.	Fire Bonz, Rock Hill
Upper Piedmont	Mike Byars	864-487-4236	3rd Tues.	Billy D's, Pine St., Spartanburg

# SCSPLS CONFERENCE & TRADE SHOW

## FEBRUARY 17-18, 2011

### REGISTRATION INFORMATION

#### SOUTH CAROLINA SOCIETY OF PROFESSIONAL LAND SURVEYORS

121 Executive Center Drive, Suite 248, Columbia, SC 29210-8419

Phone: (803) 750-7524

Fax: (803) 750-7523

Website: [www.scspls.com](http://www.scspls.com)

E-mail: [kim@scspls.com](mailto:kim@scspls.com)

Dale Swygert, SCSPLS President

Bruce King, Education Chairman

### **EARN 15 PROFESSIONAL DEVELOPMENT HOURS IN TWO DAYS**

#### **EARLY REGISTRATION FEES (Post Marked on or before January 27, 2011):**

	<u>1 DAY</u>	<u>2 DAYS</u>
MEMBER	\$160.00	\$320.00
NON-MEMBER	\$240.00	\$480.00

#### **LATE REGISTRATION FEES (Post Marked after January 27, 2011):**

	<u>1 DAY</u>	<u>2 DAYS</u>
MEMBER	\$200.00	\$400.00
NON-MEMBER	\$280.00	\$560.00

#### **ON-SITE REGISTRATION FEE:**

	<u>1 DAY</u>	<u>2 DAYS</u>
MEMBER	\$240.00	\$440.00
NON-MEMBER	\$320.00	\$600.00

- ◆ **PDH CREDITS:** Here is your chance to **earn up to 15 professional development hours** by attending full day Thursday and Friday seminars. You will receive 1 PDH per classroom hour. To receive any PDH credits, you must **sign in** at the beginning of each seminar and stay for the complete duration of each scheduled seminar. Certificates will be given at the end of each seminar. The SC Society of Professional Land Surveyors meets the requirements for a continuing education provider of the South Carolina State Board of Registration and is a qualified provider of continuing education for the North Carolina Board of Registration
- ◆ **LATE FEES ARE EFFECTIVE WHEN POST MARKED AFTER JANUARY 27, 2011.** Cancellation Policy: 100% refund 20 days prior to date of event; 50% refund 15 days prior to event; no refund ten days or less prior to date of event. Notice must be written. Substitutions will be accepted by written notice in advance. Mail to SCSPLS, 121 Executive Center Drive, Suite 248, Columbia, SC 29210-8419, or by fax, 803-750-7523.
- ◆ **SEATING WILL BE LIMITED ON A FIRST COME BASIS. REGISTER EARLY TO ASSURE YOUR CHOICE OF SEMINARS!** Lunch, breaks and social are included in seminar fees. **No cell phones or beepers in seminar rooms please.** Time to return phone calls and check into your office will be provided at breaks and lunch.
- ◆ **ATTENTION LSIT & PLS Candidates:** Friday's "**CONSOLIDATED EXAM REVIEW**" will be the last time this year SCSPLS will present this informative seminar to help prepare for the LSIT National Fundamentals of Land Surveying and PLS exams. Please pass this information on to your staff or anyone interested in preparing for a career in land surveying.
- ◆ **TRADE SHOW:** The only SCSPLS trade show for this year will be held in conjunction with the conference. Be sure to visit each booth to view the newest equipment, supplies and services. Please bring 35 business cards for drawings at each booth.
- ◆ **RADISSON HOTEL COLUMBIA & CONFERENCE CENTER:** Radisson Hotel Columbia & Conference Center, 2100 Bush River Rd., at I-20, Columbia, SC, 29210 will be our host hotel for this seminar. **Please make your reservations early as all requests for reservations must be received by Sunday, February 6, 2011.** (Group rates may no longer apply after this date.) You may make or confirm your reservation by calling the hotel directly at 803-731-0300 or 800-333-3333. Be sure to mention you would like the group rate for the SCSPLS Conference of \$99.00 for single or double rate. The Radisson Hotel Columbia & Conference Center is centrally located at 2100 Bush River Road at I-20 (Exit 63) and a half-mile from I-26 and provides complimentary airport transportation. To view the Radisson Hotel go to [www.radisson.com/columbiasc](http://www.radisson.com/columbiasc).

# CONFERENCE & TRADE SHOW SCHEDULE

- *Registration, coffee, breaks, and lunches are included in registration fee. Thursday's Exhibitor's Social is included in Thursday's registration fees.*

## **WEDNESDAY, FEBRUARY 16, 2011:**

2:00 – 6:00 PM: Trade Show Set-up – Congaree A & B, Radisson Hotel

6:30 – 8:30 PM: SCSPLS Board Meeting, Columbo's Restaurant, Radisson Hotel

## **THURSDAY, FEBRUARY 17, 2011:**

7:30 AM – 8:30 AM REGISTRATION- Coffee with Exhibitors- **CONGAREE A & B**

8:30 AM – 12:15 PM SESSION 1: Big Mistakes Made by Many Surveyors and Most Others –  
Donald A. Wilson, LLS, RPF

SESSION 2: Forensic Surveying – Bernard M. Telatovich, PE, Esq.

SESSION 3: Emerging Technologies – Daniel J. Bonenfant, PLS

10:00 AM – 10:30 AM Morning break with Exhibitors-Session 1 **CONGAREE A & B**

10:30 AM – 11:00 AM Morning break with Exhibitors-Sessions 2 & 3 **CONGAREE A & B**

10:30 AM – 12:15 PM Continuation of Morning Session 1

11:00 AM – 12:15 PM Continuation of Morning Sessions 2 & 3

12:15 PM – 1:30 PM Lunch with Exhibitors - **CONGAREE A & B**

1:30 PM – 5:00 PM SESSION 1: (Cont'd) Big Mistakes Made by Many Surveyors and Most Others

SESSION 2: (Cont'd) Forensic Surveying

SESSION 3: (Cont'd) Emerging Technologies

3:00 PM – 3:30 PM Afternoon break with Exhibitors- Session 1 **CONGAREE A & B**

3:30 PM – 4:00 PM Afternoon break with Exhibitors- Sessions 2 & 3 **CONGAREE A & B**

3:30 PM – 5:00 PM Continuation of Afternoon Session 1

4:00 PM – 5:00 PM Continuation of Afternoon Sessions 2 & 3

5:00 PM – 7:00 PM **EXHIBITOR SOCIAL** – Radisson Conference Center – **CONGAREE A & B**  
*Prize Drawings- Bring 35 of your business cards - (name badge required for entrance)*

## **FRIDAY, FEBRUARY 18, 2011:**

7:30 AM – 8:30 AM REGISTRATION - Coffee with Exhibitors

8:30 AM – 12:15 PM SESSION 1: Resolving Conflicts of Evidence – Donald A. Wilson, LLS, RPF

SESSION 2: OSHA Compliance/Safety Plan – David J. De Vita

SESSION 3: Elevation and other FEMA Certificates – Lisa Jones

SESSION 4: Consolidated Exam Review – Kristopher M. Kline, PLS, GSI

10:00 AM – 10:30 AM Morning Break with Exhibitors- Sessions 1 & 2 **CONGAREE A & B**

10:30 AM – 11:00 AM Morning Break with Exhibitors- Sessions 3 & 4 **CONGAREE A & B**

10:30 AM – 12:15 PM Continuation of Morning Sessions 1 & 2

11:00 AM – 12:15 PM Continuation of Morning Sessions 3 & 4

12:15 PM – 1:30 PM Lunch with Exhibitors- **CONGAREE A & B**

1:30 PM – 5:00 PM SESSION 1: (Cont'd) Resolving Conflicts of Interest

SESSION 2: Call to Action: Surveyors 3D Surface Prep for Machine Control –  
Adam Arrington, PE

SESSION 3: (Cont'd) Elevation and other FEMA Certificates

SESSION 4: (Cont'd) Consolidated Exam Review

3:00 PM – 3:30 PM Afternoon break - Sessions 1 & 2 **CONGAREE A & B**

3:30 PM – 4:00 PM Afternoon break- Sessions 3 & 4 **CONGAREE A & B**

4:00 PM – 5:30 PM Trade Show Break Down

3:30 PM – 5:00 PM Continuation of Afternoon Sessions 1 & 2

4:00 PM – 5:00 PM Continuation of Afternoon Sessions 3 & 4

*Thanks to the SC Board of Registration for Professional Engineers and Surveyors for funding the speaker cost for this conference!*

# ***WELCOME SCSPLS TRADE SHOW***

## ***RADISSON HOTEL CONFERENCE CENTER- CONGAREE A & B***

The annual SCSPLS Trade Show will be held in conjunction with the SCSPLS Continuing Education Conference on February 17-18, 2011 at the Radisson Hotel in Columbia! Come and see the informative displays of hardware, software, equipment, surveying and photogrammetric instruments that will be featured at the only Trade Show SCSPLS will

sponsor this year. Take advantage of this opportunity to earn 15 professional development hours or prepare for LSIT Exam and view all the new, top-of-the line items, and state-of-the-art technology under one roof. This is a great opportunity for surveyors to compare vendors and order equipment, supplies and services or to make plans for future purchases. Exhibits will be located in the Congaree A & B Ballroom which will also be the location of the breaks and lunch during the conference. Also, plan to join us Thursday evening for a “Social with the Exhibitors” where there will be plenty of hors d’oeuvres, cash bar, and prize giveaways. Bring approximately 35 of your business cards to give to exhibitors for the prize drawings. You must be registered for the seminars and present to win a prize. If you are not attending the education conference, you are invited to attend the trade show and view the latest in equipment, supplies and services for the surveying profession during non-food events or purchase a ticket to the Thursday evening social. **This is the only Trade**

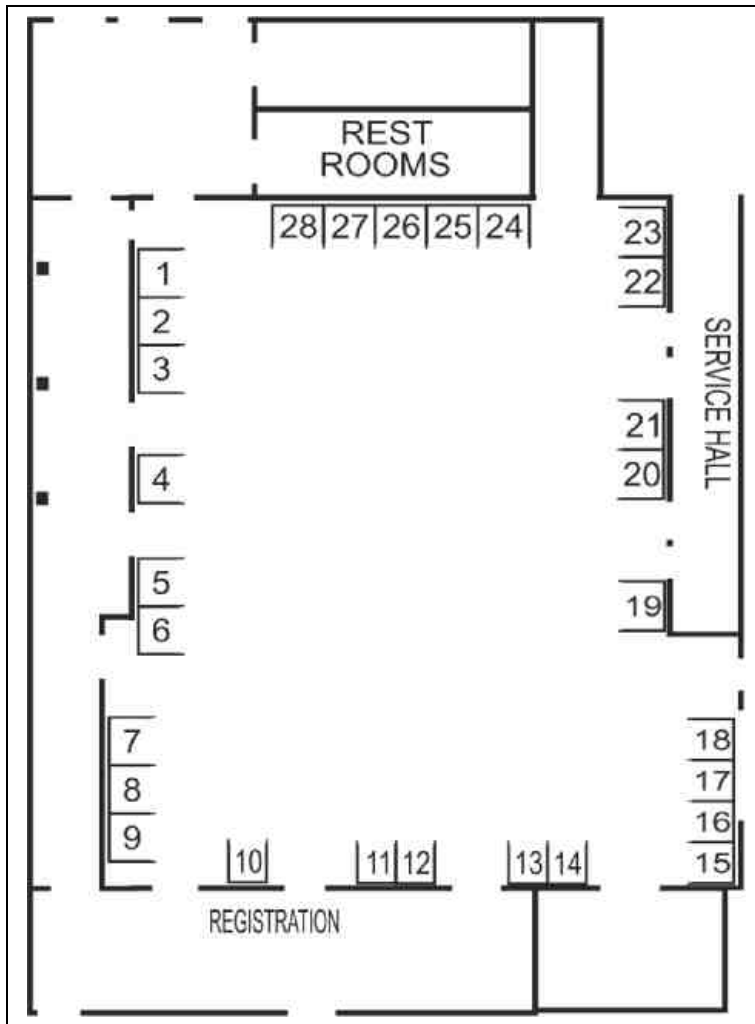

**Show SCSPLS will hold this year so mark the date on your calendar to attend.**

Registration begins at 7:30 AM in the Congaree Prefunction B area located at the back of the conference center. Once registered, join the Exhibitors on the Trade Show floor for coffee and a chance to see each booth. You will also have a chance to visit the Trade Show floor during the breaks and lunch with the Exhibitors on the Trade Show floor. The Trade Show floor will remain open on Thursday evening following the seminars for social with the Exhibitors and will close after the afternoon break on Friday. There will be hors d’oeuvres, cash bar, and prize giveaways! You must be pre-registered for the seminars to be entered into the prize drawings and attend this social. See registration page to purchase additional tickets for the “Exhibitor’s Social.”

## THURSDAY SESSIONS, FEBRUARY 17, 2011

### ♦ SESSION 1: BIG MISTAKES MADE BY MANY SURVEYORS AND MOST OTHERS

(Earn 7 ½ PDHs for attending **both** the morning and afternoon sessions)

A little knowledge can be dangerous: there are several pitfalls that are easy to fall into! This seminar focuses on those which often mislead people, sometimes even the knowledgeable, careful surveyor. Topics discussed are: searching in the wrong places for information; believing that all abutting properties extend to the centerline of a road; trying to derive answers without any or from inadequate research; accepting the wrong evidence; being misled by numbers; confusing adverse relationships with types of agreement.



**Donald A. Wilson, LLS, RPF**  
**Land and Boundary Consultants, Inc.**  
**Newfields, NH**

Don is President of Land and Boundary Consultants, Inc., based in southeastern New Hampshire, and has been in practice as a land boundary consultant about 40 years. Don is both a licensed land surveyor and professional forester. He has presented seminars on a variety of topics including description interpretation, boundary evidence, surveying law, and various aspects of forensic science. Don is a member of, and has been active in, many surveying, mapping, and forestry organizations. He is past president of both the Maine Society of Land Surveyors and the New Hampshire Land Surveyors

Association. In addition to over 200 technical publications in several disciplines, Don has been involved with the writing of over 50 books. The 5th editions of *Evidence & Procedures for Boundary Location* and its companion title, *Boundary Control and Legal Principles*, both of which he is a co-author, are the leading surveying textbooks. His recent publication, *Interpreting Land Records*, is proving to be a favorite among attorneys, title examiners and surveyors. He has written two other boundary-related texts as well as researched and compiled the subject matter for seven state boundary and surveying law books. His latest book, *Forensic Procedures for Boundary & Title Investigation*, is soon to be released for publication. Don is a former faculty member of the University of Maine where he taught surveying in the School of Forestry and the Department of Civil Engineering. He is also a former faculty member at the University of New Hampshire where he continues to teach courses for the UNH Professional Development & Training Program. He is a contributing writer to Professional Surveyor Magazine and a member of the Professional Surveyor/Red Vector "Dream Team" providing on-line education for surveyors and related professionals. Presently this cooperative is offering eleven separate courses authored by Don with more currently being developed.

### ♦ SESSION 2: FORENSIC SURVEYING

(Earn 7 ½ PDHs for attending **both** the morning and afternoon sessions)

This workshop, designed for intermediate to advanced surveyors who have extensive experience and may be involved with or interested in the forensic field, will address various areas where a surveyor may be involved in litigation-related matters. In formulating the opinions required in such cases, the expert surveyor must be familiar with, in addition to his technical expertise, numerous complicated legal matters including the nature of lawsuits, the rules of evidence, civil procedure, rules of discovery, property law, tort law, other legal principles, and what the role of an expert is in litigation. This workshop will begin examining the role and duties of the expert witness, followed by the broad definition of "forensic surveying." In addition, legal concepts such as jurisdiction, civil procedure, and evidence will be reviewed, as well as the elements of a lawsuit, which include the filing of a complaint, pleadings, interrogatories, and depositions. The primary focus of the workshop will be on the types of cases in which forensic surveyors participate. The classic case, the boundary line dispute, will be examined using *Rapids Parish Police Jury v. Grant Parish Police Jury*, 924 So.2d 357, as a case study into not only procedural discussions of surveying boundary disputes, but also the importance of competent and

thorough forensic surveying work. This case, as well as numerous other select cases, expands on “Daubert Hearings” as well as the importance of retracement, preparation, and a quality surveyor’s report. In addition, other types of “non-classic” forensic surveying matters will be examined, including working as a forensic surveyor gathering data at an accident or crime scene and examining the work of other surveyors to determine adequate methodology and procedure. The workshop will review these scenarios, covering the need for certain evidentiary information, how to document the investigation, and what questions to ask. Forensics involves gathering information and/or evidence for matters in litigation. The surveyor is uniquely trained to meticulously gather information on the project site every day. This skill makes the need for a forensic surveyor self-evident and this workshop will broaden attendees’ knowledge and skills such that they better understand the forensic surveyor’s role in litigation.

## **Bernard M. Telatovich, P.E., Esq.**

**Consulting Services & Investigations, LLC  
Bethlehem, PA**



Bernard M. Telatovich, President of CSI, opened the business in 2005 with the intent of providing quality, competent and timely services, while maintaining a continuing professional engineering practice in Civil Engineering. Mr. Telatovich’s experience includes more than twenty-five years of experience in the engineering, construction and legal fields. He holds a B.S. Degree from Lehigh University and a J.D. from the University of Florida. His continuing professional education includes Accident Reconstruction from the University of Florida and Northwestern University. Extensive computer reconstruction and simulation in accident reconstruction was obtained from the University of North Florida. He has been providing forensic services since 1994. For more information on Mr. Telatovich

and his company, please visit [www.csi-experts.com](http://www.csi-experts.com).

## **♦ SESSION 3: EMERGING TECHNOLOGIES**

(Earn 7 ½ PDHs for attending **both** the morning and afternoon sessions—continuation of class on Friday)

The current “Buzzword” for surveying today is Terrestrial Scanning and BIM. This class will begin with the basics of scanning. We will cover the types of scanners and their uses. We discuss how to plan and perform a scanning project and how to coordinate a scanning project. We will work through the process of scanning a project, registering the scans, segmenting the scan data into manageable chunks, and modeling. We will transfer the model into AutoCAD and into Navisworks. We will discuss a BIM from a Civil/Survey point of view using a roadway project. We will demonstrate the concept of BIM to field using Civil 3D and Trimble Link to export data to the field for layout. To top off the day we will end with a presentation on Mobile scanning, the new buzzword for the future.

## **Daniel J. Bonenfant, PLS**

**Duncan- Parnell  
Columbia, SC**



Dan has been involved with surveying and civil engineering for more than 25 years. He started in 1983 as a chain man on a construction crew, then worked his way up to a survey manager in charge of 6 field crews. He later moved into the design side of civil engineering, and went on to become a Registered Land Surveyor in South Carolina. In 1995, he added Autodesk software training and support to his resume, specializing in surveying and civil engineering products. In 2001, Dan returned to design and surveying, then joined Duncan-Parnell in 2008 as an Autodesk Application Engineer providing software training and support for AutoCAD, AutoCAD Raster design, Autodesk Civil 3D, Autodesk 3ds Max Design, Autodesk Navisworks, AutoCAD Map 3D, and Autodesk Revit Structure. Dan is also the primary trainer and support technician for Trimble’s spatial imaging hardware and software products including the VX Spatial Station, GX 3D Scanner and CX 3D Laser Scanner. Dan also provides support and training for the Trimble Spatial Imaging software products including Trimble RealWorks, Trimble Access, PointScape, LM80 Desktop and Trimble Point Creator Pro.

## **FRIDAY SESSIONS, FEBRUARY 18, 2011**

### ◆ **SESSION 1: RESOLVING CONFLICTS OF EVIDENCE**

(Earn 7 ½ PDHs for attending both morning and afternoon session)

This seminar is a one-day presentation analyzing the types of conflicts of evidence, and a discussion of rules for the resolution of those conflicts. Included are conflicts between documentary, physical and parole evidence, and the effect of occupation and possession independent of record title.



**Donald A. Wilson, LLS, RPF**  
**Land and Boundary Consultants, Inc.**  
**Newfields, NH**

Don is President of Land and Boundary Consultants, Inc., based in southeastern New Hampshire, and has been in practice as a land boundary consultant about 40 years. Don is both a licensed land surveyor and professional forester. He has presented seminars on a variety of topics including description interpretation, boundary evidence, surveying law, and various aspects of forensic science. Don is a member of, and has been active in, many surveying, mapping, and forestry organizations. He is past president of both the Maine Society of Land Surveyors and the New Hampshire Land Surveyors Association. In addition to over 200 technical publications in several disciplines, Don has been involved with the writing of over 50 books. The 5th editions of *Evidence & Procedures for Boundary Location* and its companion title, *Boundary Control and Legal Principles*, both of which he is a co-author, are the leading surveying textbooks. His recent publication, *Interpreting Land Records*, is proving to be a favorite among attorneys, title examiners and surveyors. He has written two other boundary-related texts as well as researched and compiled the subject matter for seven state boundary and surveying law books. His latest book, *Forensic Procedures for Boundary & Title Investigation*, is soon to be released for publication. Don is a former faculty member of the University of Maine where he taught surveying in the School of Forestry and the Department of Civil Engineering. He is also a former faculty member at the University of New Hampshire where he continues to teach courses for the UNH Professional Development & Training Program. He is a contributing writer to Professional Surveyor Magazine and a member of the Professional Surveyor/Red Vector "Dream Team" providing on-line education for surveyors and related professionals. Presently this cooperative is offering eleven separate courses authored by Don with more currently being developed.

### ◆ **SESSION 2 (MORNING): OSHA COMPLIANCE – WRITING A SAFETY PLAN**

(Earn 7 ½ PDHs for attending **both** the morning and afternoon sessions)

This seminar will cover the importance of safety, importance of building a company safety culture, role of management in safety, safety Management System, benefits of a successful safety program and OSHA.

**David J. De Vita**  
**Carolina Safety Consultants**  
**Greenville, SC**



David De Vita, founder and president of CSC, is passionate about safety. He has dedicated his professional career to providing leading-edge training and consulting to organizations. David's career in safety consulting and implementation spans twenty years, and includes strategic roles with many leading Southeastern general and specialty contractors, as well as time in the healthcare and recreation fields. He founded Carolina Safety Consultants after serving as a loss control and workplace safety consultant for such organizations as Continental Insurance, CNA Insurance, the Carolinas Association of General Contractors (CAGC), and Rosenfeld Einstein Insurance. David's personal involvement and experience is a hallmark of every CSC engagement. His focus is people. He believes that when management and employees both understand the culture of safety, they will be enthusiastic about compliance procedures and performance will increase.



## ♦ **SESSION 2 (AFTERNOON): CALL TO ACTION – SURVEYORS 3D SURFACE PREP FOR MACHINE CONTROL**

With the escalating acceptance of 3D machine control for road building, land forming, and general earthmoving, land surveyors have an opportunity to provide valuable knowledge and experience into this market. This class will provide a general overview of this market, its potential, and the necessary technical elements that make this technology so dynamic. Videos of working machines will be shown in addition to accuracy capabilities. A detailed exercise showing the software steps required to prepare a working surface, verify it, and make the surface suitable for a machine will be discussed and demonstrated. Current surface import and export formats will be covered as well as the survey control requirements for setting up and maintaining a successful job will be discussed. Lastly an insight in the latest surface management techniques as well as machine monitoring systems will be demonstrated and discussed.



**Adam Arrington, PE**  
**Earl Dudley, Inc.**  
**Birmingham, AL**

Adam Arrington is Vice President and Systems Sales Manager for Earl Dudley Inc., a Surveying and Mapping Dealership, with six offices across the southeast. Adam has specialized in this industry for 20 years providing solutions to clients that are looking for new and innovative ways to solve today's complex mapping, design, and measuring tasks. He is an expert in applications which utilize high accuracy GPS, 3D laser scanning, CAD software solutions, industrial measuring and structural monitoring. Adam holds a Mechanical Engineering Degree from Clemson University and is a Registered Professional Engineer in the State of Alabama.

## ♦ **SESSION 3: ELEVATION AND OTHER FEMA CERTIFICATES**

(Earn 7 ½ PDHs for attending **both** the morning and afternoon sessions)

What's new with SC Flood Maps? Learn about the changes you'll be seeing with the new release of the FIRMs later this year. FEMA Letters of Map Change: A Guide to Understanding the Forms, Procedures, and Requirements including changes related to Endangered Species. This presentation will provide an explanation of what FEMA Letters of Map Change (LOMC) are, why they are necessary, who can benefit, and how; a review of Flood Insurance Rate Maps and Flood Insurance Studies; a detailed examination of the types of LOMCs, the forms required, and additional data recommended for submittal; knowledge of common problems and mistakes, which can cause up to three months of delays; and walk through the LOMC case process, available resources, and examples so that your next application is processed expeditiously. In addition, the presentation will provide details regarding FEMA's new Procedure Memorandum 64 – Compliance with the Endangered Species Act for Letters of Map Change and what that means in South Carolina.

**Lisa S. Jones, CFM**  
**Columbia, SC**

**Nathan Hayden, CFM - Michael Taylor, PE, CFM - Chris Mack, PE**  
**AECOM**



Jones served the State of SC as the NFIP and Risk MAP Coordinator for over sixteen years with the SCDNR prior to her departure for the private sector. During her tenure at SCDNR she provided leadership; cultivated the Flood Mitigation, Community Assistance Programs; the State's Map Modernization initiatives from their inception. Jones started her career in NC where she was immersed in emergency management response, disaster recovery, mitigation; training which provided her a wealth of experience for which to establish a premier program in SC. Mrs. Jones was elected Chair of the Association of State Floodplain Managers in 1999. She has been

involved in emergency; floodplain management in state government for over twenty-five years. Mrs. Jones served on the FEMA's CRS Task Force for seven years. Jones co-founded both the NC Association of Floodplain Managers; the SC Association for Hazard Mitigation. Mrs. Jones' institutional knowledge and expertise in her field affords her opportunities to testify before Congress, serve on various national, State taskforces, committees and work groups. **Nathan Hayden, CFM** is AECOM's LOMA Coordinator for FEMA Region IV. He coordinates all MT-1 cases for South Carolina. **Michael Taylor, PE, CFM** is a Project Manager with AECOM's Atlanta office. He has 10 years of hydrology and hydraulics experience. **Chris Mack, PE**, is a Coastal Project Manager with AECOM out of the Charleston, SC office. Chris has over 19 years of coastal and water resource planning, engineering, design, and management experience gained in the public and private sectors. This includes approximately 13 years with the US Army Corps of Engineers and 6 years with private coastal engineering and consulting firms. Chris has conducted or managed coastal storm surge modeling, hazard analysis, and flood plain mapping for FEMA Flood Insurance Studies (FIS) and Digital Flood Insurance Rate Map (DFIRM) production throughout the Atlantic and Gulf coasts. Chris is currently leading a number of FEMA coastal flood study update projects along the Southeast coast in the Carolinas, Georgia and Florida.

## ◆ **SESSION 4: P.L.S. & L.S.I.T. COMBINED REVIEW – BOUNDARY RETRACEMENT PRINCIPLES**

(Earn 7 ½ PDHs for attending **both** the morning and afternoon sessions)

The topics that will be covered in this consolidated exam review include: Communications Skills; Intent of the Parties; Rules of Construction; Controlling vs. Informative Terms; Ethical Questions; Junior vs. Senior Title; Simultaneous vs. Sequential Conveyance; The basic Deed; Sufficiency of Research; Roads, Rights of Way, and Easements; creation, abandonment, and reversion; Original vs. Replacement Monuments and their relative value; Proportioning; Basic Water Boundaries, including accretion, erosion, and avulsion.



**Kristopher M. Kline, PLS, GSI**  
**2Point, Inc.**  
**Alexander, NC**

A graduate of Bridgewater College (B.S. in General Science), Kris began surveying in 1984 and was licensed in North Carolina in 1991. At that point, he became a partner in an existing surveying firm until his April 2000 departure. Since that time he has remained self-employed at his firm 2Point, Inc. His specialties are difficult boundary retracements, forensic surveying, and courtroom preparation and testimony. A graduate of the North Carolina Society of Surveyors (N.C.S.S.) Institute, Kris has attended numerous seminars on surveying law, State Statutes, Boundary Retracement, and Easements. He has taught classes on Boundary Retracement, Real Estate Law as it relates to land surveying, and

North Carolina Statutes. He served for 5 years as the Chairman of the Education Committee for N.C.S.S. and was also formerly Chairman of the Standards of Practice Committee. Kris has recently been accepted as a contributor by "Point of Beginning" Magazine; his column "Unmistakable Marks" appears four times a year.

---

## ***YOUR CHECK LIST***

- **REGISTER EARLY FOR BEST RATES AND YOUR FIRST CHOICE OF SEMINARS**
- **BRING COPY OF YOUR REGISTRATION FORM FOR YOUR INFORMATION**
- **BRING 35 BUSINESS CARDS FOR EXHIBITOR DRAWINGS**
- **REGISTRATION IN CONGAREE PREFUNCTION AREA EACH MORNING, 7:30-8:30 AM. CLASSES BEGIN PROMPTLY AT 8:30 AM.**
- **SEMINARS HELD: RICHLAND, FAIRFIELD, SALUDA, CALHOUN, NEWBERRY AND CAPITAL CLASSROOMS**
- **BREAKS, LUNCH, EXHIBITOR RECEPTION INCLUDED IN FULL REGISTRATION**

# ***SPONSORSHIP APPLICATION***

## **SCSPLS 2011 CONFERENCE AND TRADE SHOW**

**FEBRUARY 17-18, 2011**

**Radisson Hotel and Conference Center, Columbia, SC**

**Please indicate amount adjacent to the functions you wish to sponsor and return by January 17, 2011.**

<u>FUNCTION</u>	<u>DATE</u>	<u>CO-SPONSOR FEE</u>	<u>FULL SPONSOR</u>	<u>TOTAL AMOUNT</u>
<b><u>Thursday, February 17, 2011</u></b>				
Thursday AM Coffee		\$200.00	\$ 800.00	
Thursday Breaks		\$250.00	\$1000.00	_____
Thursday Lunch		\$400.00	\$3000.00	_____
Thursday Social		\$400.00	\$3000.00	_____
<b><u>Friday, February 18, 2011</u></b>				
Friday AM Coffee		\$200.00	\$ 800.00	
Friday Breaks		\$250.00	\$1000.00	_____
Friday Lunch		\$300.00	\$1500.00	_____
OTHER:				
Marketing Expenses		\$400.00	\$2500.00	_____
Audio Visual Expenses		\$400.00	\$2,000.00	_____
Supplies for Conference		\$400.00	\$1,000.00	_____
Complimentary Trade Show Registration for Schools, NSPS, and other non-profit organizations		\$200.00		_____
DONATION (OTHER) _____				\$ _____
<b>TOTAL AMOUNT ENCLOSED</b>				<b>\$ _____</b>

Recognition of sponsored events will be at the Conference and Trade Show, in the newsletter "The Carolina Benchmark" and on the SCSPLS website.

NAME \_\_\_\_\_

COMPANY \_\_\_\_\_

ADDRESS \_\_\_\_\_

CITY, STATE, ZIP \_\_\_\_\_

PHONE \_\_\_\_\_ FAX \_\_\_\_\_ E-mail: \_\_\_\_\_

Please complete and return with payment to:

SCSPLS, 121 Executive Center Dr., Ste. 248, Columbia, SC 29210-8419



**SOUTH CAROLINA SOCIETY OF PROFESSIONAL LAND SURVEYORS, INC.**  
**APPLICATION FOR MEMBERSHIP**

**Please mark all appropriate spaces:**

☐ New Membership ☐ Renewal Membership Fiscal Year: \_\_\_\_\_  
**Check** membership applied for: ☐ Full Member ☐ Associate Member (I am working towards registration.) ☐ Sustaining Member  
☐ Complimentary ☐ Emeritus Member ☐ Student Member (include transcript)

See qualifications for membership categories and related dues structure on back.

School Attending: \_\_\_\_\_

Name \_\_\_\_\_  
(Last) (First) (Middle Initial)  
Preferred Name or Nickname \_\_\_\_\_ Spouse Name \_\_\_\_\_

Employed by \_\_\_\_\_  
Engaged in: ☐ Self-Employed ☐ Private Practice ☐ Industry ☐ Public Utility ☐ Education  
☐ Government Agency: Municipal \_\_\_\_\_ County \_\_\_\_\_ State \_\_\_\_\_ Federal \_\_\_\_\_  
☐ Other (describe) \_\_\_\_\_

Occupation \_\_\_\_\_

☐ Sustaining Member Information:  
Product or Service \_\_\_\_\_  
Authorized Dealer \_\_\_\_\_

**CHECK preferred mailing address below:**

☐ Business Address \_\_\_\_\_  
(Street & Number) (City, State, Zip)

Telephone: Office \_\_\_\_\_ Facsimile \_\_\_\_\_ E-Mail \_\_\_\_\_

☐ Home Address \_\_\_\_\_  
(Street & Number) (City, State, Zip)

Telephone: Home \_\_\_\_\_ Facsimile \_\_\_\_\_ E-Mail \_\_\_\_\_

☐ I wish to receive my brochures by email ☐ I prefer US bulk mail to address checked above.

Birth: Date \_\_\_\_\_ City \_\_\_\_\_ State \_\_\_\_\_

Education, Years completed: High School \_\_\_\_\_ College \_\_\_\_\_ Other \_\_\_\_\_

Diplomas, Certificates, Degrees \_\_\_\_\_

Name of School(s) \_\_\_\_\_

Professional Registration: ☐ Land Surveyor State \_\_\_\_\_ Reg. No. \_\_\_\_\_

State \_\_\_\_\_ Reg. No. \_\_\_\_\_

(State & Registry Number) ☐ LSIT State \_\_\_\_\_ Reg. No. \_\_\_\_\_

☐ Other State \_\_\_\_\_ Reg. No. \_\_\_\_\_

Local SCSPLS Chapter Membership \_\_\_\_\_

SCSPLS Officer \_\_\_\_\_  
(State Officer or Local Chapter Officer) (Office, Group, Year)

Other Professional Memberships \_\_\_\_\_

**Total amount enclosed** **Check No.** \_\_\_\_\_ **\$** \_\_\_\_\_

**Make check payable to SCSPLS. Return to: SCSPLS, 121 Executive Center Dr., Suite 248, Columbia, SC 29210**

**Note: Dues (Check next page for amount) Call office for credit card payments.**

(Your membership fees are not deductible as a charitable expense, but may be deductible under other tax law provisions 3% of dues are used for political and lobbying activities.)

**I hereby make application for admission to the South Carolina Society of Professional Land Surveyors, Inc. and if approved, agree to abide by Constitution and By Laws. Remittance of dues shall be construed as acceptance of the terms set forth herein. Failure to remit within the designated period of time shall result in termination of all benefits of membership including all insurance.**

\_\_\_\_\_  
Signature of Applicant

\_\_\_\_\_  
Date

## **PURPOSE**

The S. C. Society of Professional Land Surveyors (SCSPLS) was formed to advance the public welfare and the professional, social and economic interests of the Registered Land Surveyor by promotion of education, legislation and public relations through the establishment and maintenance of high ethical standards and practices. It is proposed to bring about coordination between the Land Surveying and Engineering Professions through close cooperation with representative organizations of Professional Engineers.

## **MEMBERSHIP CATEGORIES**

SCSPLS Membership year is from July 1 through June 30 of each year.

\$165.00 per year for Full members plus \$10.00 application fee = \$175.00

\$200.00 per year for Sustaining members plus \$10.00 application fee = \$210.00

\$ 65.00 per year for Associate members plus \$10.00 application fee = \$75.00

\$ 40.00 Emeritus Members Application and renewal fee \$40.00

\$ 25.00 per year for dues for Student members, Application fee waived = \$25.00

## **FULL MEMBERS**

Professional Land Surveyors who are of good standing in South Carolina or any state or territory of the United States that regulates the practice of land surveying and the licensing of Registered Land Surveyors.

Annual Dues: \$165.00. Application fee: \$10.00.

## **ASSOCIATE MEMBERS**

Land Surveyors In Training and any person who is working toward registration as a Land Surveyor and has not qualified for the exams may become an Associate Member of the Society. Associate members shall have all rights and privileges of membership except the holding of office or balloting in the election of officers.

Annual Dues: \$65.00. Application fee: \$10.00

## **SUSTAINING MEMBERS**

Any commercial or professional institution or individual interested in surveying and mapping, the manufacture of instruments or equipment for this work or the production or compilation of maps. Sustaining members shall have all rights and privileges of full membership except the holding of office and voting.

Annual Dues: \$200.00. Application fee: \$10.00

## **EMERITUS MEMBERS**

Any member who has reached the age of 65 and has been in good standing for 15 or more consecutive years with the SCSPLS may apply for Emeritus Membership subject to approval by the Board. Emeritus members have all rights and privileges of full membership.

Application and Annual Renewal Fee: \$40.00 Annual Dues: Exempt.

## **HONORARY MEMBERS**

The Board may bestow upon any person, who has rendered acknowledged eminent service and who has made valuable and outstanding contributions to the profession, the title of Honorary Member. Honorary members shall have all rights and privileges of full membership except the holding of office and balloting in the election of officers.

Annual Dues and Application Fee: Exempt.

## **STUDENT MEMBERS**

Any student of a school of higher education recognized by the Board of Directors who is interested in Land Surveying or related professions. Student members shall not be eligible for insurance, to vote or to hold office in the Society.

Annual Dues: \$25.00. Application fee waived.

---

## **FOR OFFICIAL USE ONLY:**

Date Application Received at the SCSPLS Office: \_\_\_\_\_ Total Amount Enclosed \$ \_\_\_\_\_ Ck No. \_\_\_\_\_

Membership Committee Action Date: \_\_\_\_\_ Board Action Date: \_\_\_\_\_

Certificate & Membership Card Mailed: \_\_\_\_\_ ID# \_\_\_\_\_

---

Membership Committee Chairman or Co-Chairman

# CONFERENCE REGISTRATION FORM

*Seating will be limited. Seminars will be filled on a first-come basis in order registration forms are received. Where first choice is not available, seminar registration for next available seminar selected below will be assigned. Please check your first and second choice selections below for each day.*

## Check Choices

<u>1<sup>st</sup></u>	<u>2<sup>nd</sup></u>
-----------------------	-----------------------

### **THURSDAY, FEBRUARY 17, 2011 SESSIONS:**

SESSION 1: Big Mistakes Made by Surveyors (7 ½ PDH – AM & PM Sessions)

☐ ☐

SESSION 2: Forensic Surveying (7 ½ PDH – AM & PM Sessions)

☐ ☐

SESSION 3: Emerging Technologies (7 ½ PDH- AM & PM Sessions)

☐ ☐

### **FRIDAY, FEBRUARY 18, 2011 SESSIONS:**

SESSION 1: Resolving Conflicts of Interest (7 ½ PDH – AM & PM Sessions)

☐ ☐

SESSION 2: AM: OSHA Compliance, Writing a Safety Plan - (7 ½ PDH- AM & PM Sessions)  
PM: Call to Action – Surveyors 3D Surface Prep for Machine Control

☐ ☐

SESSION 3: Endangered Species, Extensions on Preferred Risk Policies (7 ½ PDH- AM & PM Sessions)

☐ ☐

SESSION 4: Consolidated Exam Review (7 ½ PDH- AM & PM Sessions)

☐ ☐

NAME \_\_\_\_\_

COMPANY \_\_\_\_\_

ADDRESS \_\_\_\_\_

CITY \_\_\_\_\_ STATE \_\_\_\_\_ ZIP \_\_\_\_\_

PHONE: BUSINESS \_\_\_\_\_ FAX \_\_\_\_\_

Registration No. \_\_\_\_\_ State \_\_\_\_\_ E-Mail Address \_\_\_\_\_

Please check:	<u>Early Registration</u>		<u>Late Registration (after Jan. 27)</u>		<u>On-site</u>	
	<u>One Day</u>	<u>Two Days</u>	<u>One Day</u>	<u>Two Days</u>	<u>One Day</u>	<u>Two Days</u>
<b>SCSPLS MEMBER FEE ENCLOSED:</b>	<input type="checkbox"/> \$160	<input type="checkbox"/> \$320	<input type="checkbox"/> \$200	<input type="checkbox"/> \$400	<input type="checkbox"/> \$240	<input type="checkbox"/> \$440
<b>SCSPLS NON-MEMBER FEE ENCLOSED:</b>	<input type="checkbox"/> \$240	<input type="checkbox"/> \$480	<input type="checkbox"/> \$280	<input type="checkbox"/> \$560	<input type="checkbox"/> \$320	<input type="checkbox"/> \$600

**ADDITIONAL SOCIAL TICKETS** ☐ \$35.00 x \_\_\_\_\_ (# tickets) = \$ \_\_\_\_\_

**TOTAL \$ \_\_\_\_\_**

SCSPLS APPLICATION FOR NEW MEMBERSHIP ENCLOSED WITH FEES: Yes \_\_\_\_\_

(New membership applicants will be assessed the SCSPLS member fee of \$175 for full and sustaining member and \$75.00 for associate member. Application must be received with registration to be considered a SCSPLS member for this seminar.)

Check # \_\_\_\_\_ enclosed for the following amount \$ \_\_\_\_\_

Call SCSPLS office for credit card payments: 803-750-7524.

**Mail form to: SCSPLS, 121 Executive Center Dr, Ste 248, Columbia, SC 29210**

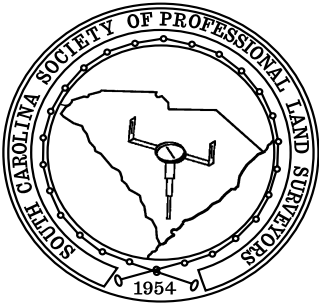

## ***SOUTH CAROLINA SOCIETY OF PROFESSIONAL LAND SURVEYORS, INC.***

121 Executive Center Dr., Suite 248, Congaree Bldg., Columbia, SC 29210

PHONE (803) 750-7524

E-Mail: [scspls@bellsouth.net](mailto:scspls@bellsouth.net)

Web Site: [www.scspls.com](http://www.scspls.com)

### **BENEFITS OF MEMBERSHIP**

#### **Annual Convention**

The SCSPLS holds an annual convention each year. Attendees exchange ideas, hear guest speakers for related professions and socialize at planned events and meals. The annual business meeting is also held during the convention, and at this time, officers and directors are named for the coming year. Lifelong friendships are begun and renewed at the Convention. This event is planned to benefit each category of membership and is the highlight of our year. A variety of events, from leisure to technical, are planned for everyone. Individuals, couples or families with children can obtain tremendous benefits from this event. Out-of-state guests are always in attendance with current activities and information from our Colonial States.

#### **Education**

Educational seminars and workshops are conducted at various regional locations around the State. Continuing education units may be earned through these programs to meet the SC State Board of Registration requirements. These educational programs are designed to provide a wide variety of topics including business, legal aspects, as well as surveying technology. SCSPLS is an Approved Sponsor for the presentation of Continuing Professional Competency courses or programs by the N.C. Board of Registration for Professional Engineers and Land Surveyors. While the SC State Board of Registration does not pre-qualify providers, programs sponsored by the SC Society of Professional Land Surveyors are designed to fulfill the requirements for Continuing Professional Competency in South Carolina.

#### **Insurance**

Full, Sustaining, Associate, Complimentary and Emeritus Members will be entitled to a \$10,000 Life Insurance and \$10,000 Accidental Death and Dismemberment insurance policy as member of the SCSPLS (Be sure to mail insurance application to insurance agent listed.)

#### **Membership Directory**

A directory of the current members and officers of the SCSPLS is published for distribution to the membership. The SCSPLS Constitution, By-Laws and information on state SCSPLS Chapters are printed in the directory.

#### **Newsletter**

The newsletter, *The Carolina Benchmark*, contains articles of interest to the membership including activities of the Society, general business tips, and timely topics of interest to surveyors. This is also an excellent opportunity for Sustaining members to advertise their equipment and services.

#### **Scholarship**

The Society is proud of the scholarships awarded in the past and will continue this program to assist land surveying students in their educational goals.

#### **Trade Show**

SCSPLS will hold the annual trade show along with the Education Conference to be held in Columbia. This affords members an opportunity to see the most current equipment and services on the market for the surveying profession.

#### **National and State Affiliations**

SCSPLS is an affiliate member of the American Congress of Surveying and Mapping and sponsors delegates to:

National Society of Professional Surveyors

State Mapping Advisory Committee

SC Council of Engineering and Surveying Societies

GIS Advisory Committee

SC Utilities Committee

SC Society of Professional  
Land Surveyors  
121 Executive Center Dr., Ste. 248  
Columbia, SC 29210

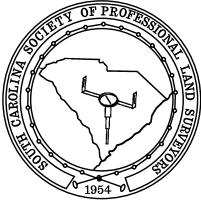

Forwarding Service Requested

PRSRT STD  
US POSTAGE  
PAID  
COLUMBIA SC  
PERMIT 550

---

## SCSPLS CONFERENCE AND TRADE SHOW FEBRUARY 17-18, 2011

- ◆ OBTAIN UP TO *15* PROFESSIONAL DEVELOPMENT HOURS IN *TWO DAYS*
- ◆ *TRADE SHOW*: SEE THE MOST CURRENT EQUIPMENT AND SERVICES ON THE MARKET FOR THE SURVEYING PROFESSION
- ◆ RADISSON HOTEL AND CONFERENCE CENTER  
2100 BUSH RIVER ROAD, COLUMBIA, SC 29210  
Make Reservations by February 6, 2011  
803-731-0300 or 800-333-3333



### MAIL REGISTRATION FORM TO:

SCSPLS, 121 Executive Center Drive, Suite 248, Columbia, SC 29210

EARLY REGISTRATION DEADLINE  
JANUARY 27, 2011